

John Kline

C 33-62

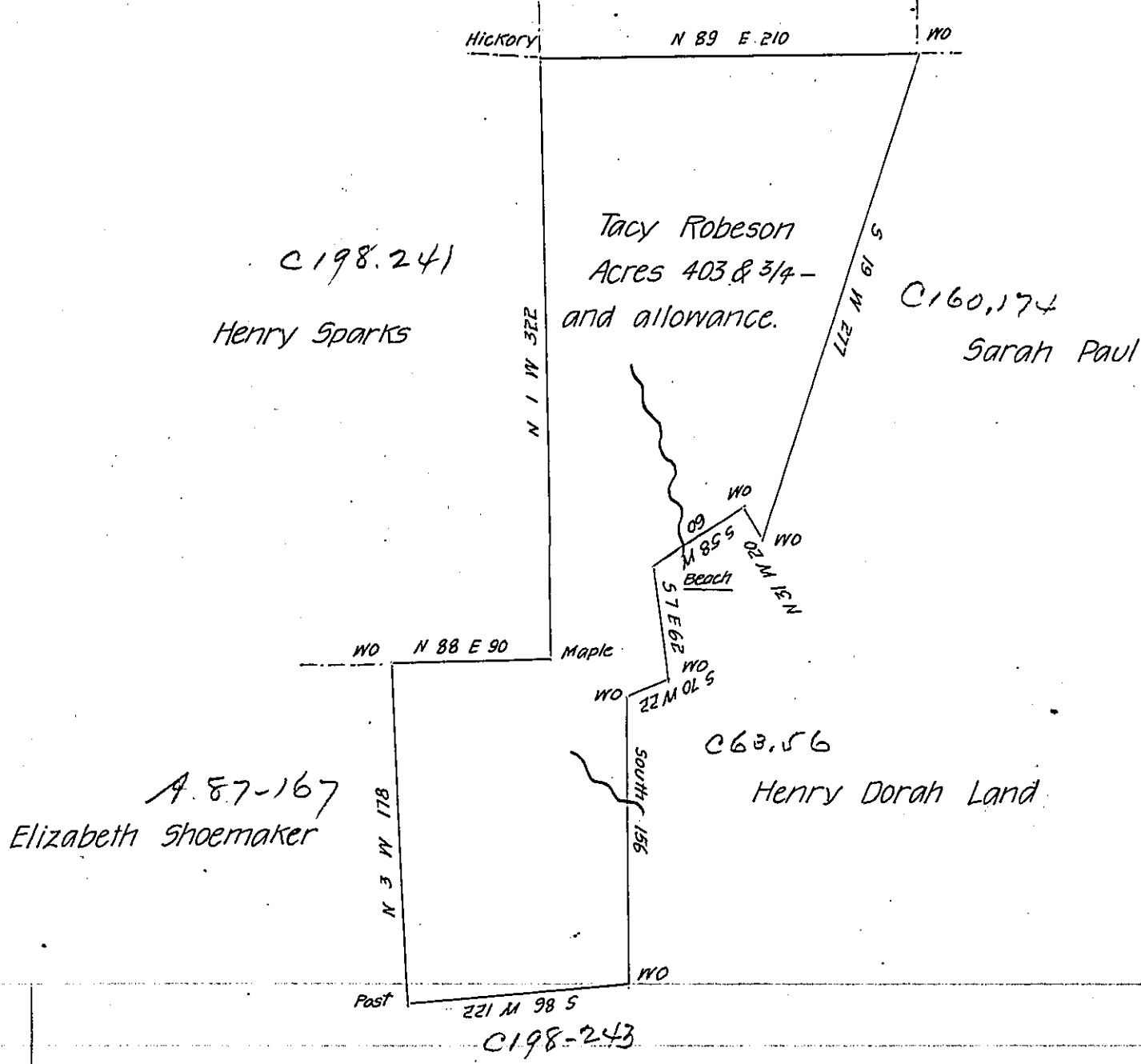

A draught of a tract of land situate on the head of Shinsu  
 Run in Green township Surveyed December 20<sup>th</sup> day 1794 Con-  
 taining 403 acres & 120 perches with the allowance of six per cent  
 & c in pursuance of a warrant granted April 14<sup>th</sup> day 1794 to Tacy  
 Robeson.

Jno. Hoge D.S.

To Daniel Brodhead Esq<sup>r</sup> S. G.

IN TESTIMONY that the above is a copy of the original remaining on file in  
 the Department of Internal Affairs of Pennsylvania, made  
 conformably to an Act of Assembly approved the 16th day of  
 February, 1833, I have hereunto set my Hand and caused  
 the Seal of said Department to be affixed at Harrisburg,  
 this twenty-seventh day of October 1906.

*Isaac B. Brown*  
 Secretary of Internal Affairs.